



# SCHEMATICS

CUSTOMER SERVICE  
**1-800-446-1071**

Export (general) / Charcoal / Bar-B-Kettles

[VIEW ALL](#)

MODEL #: 13601004 DESCRIPTION: WEBER KETTLE PLUS 47CM BLK W/GBS (2016) (EU)

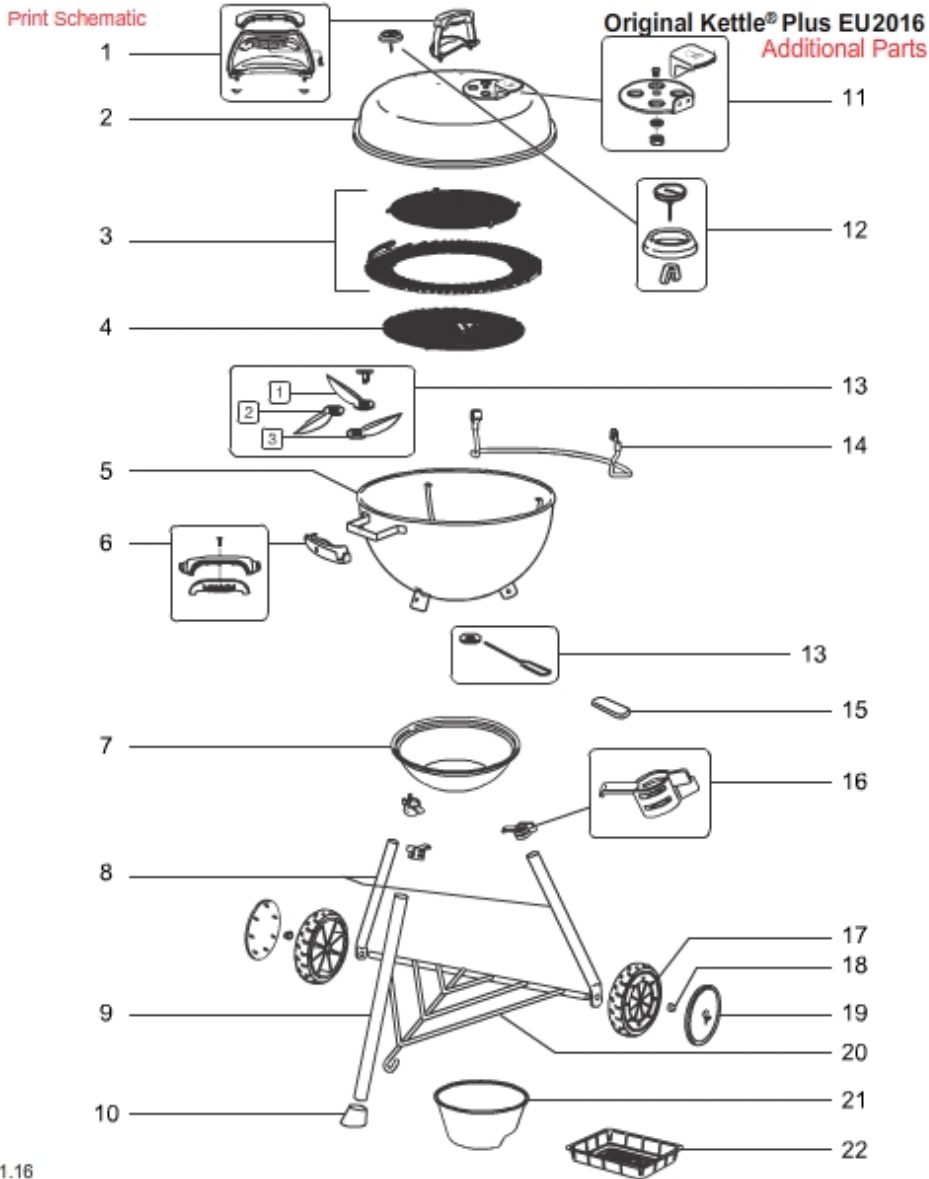

11.16

SEQ	DESCRIPTION	PART#
A	Assembly guide, Kettle Plus, EU	52367
A	Owner's Guide, 47 cm Kettle Plus, export	54635
B	Ash catcher clips, '17, export	91792
B	D-HDWE 18" T/A RED CAP CHAR 17	91788
G	Measuring cup, black	80664

H	Large drip pan, single	93100
1	Handle kit w/sheild, black, export	66779
2	Lid assembly, black, 47 cm kettle plus, export	66778
3	Gourmet BBQ System cooking grate, export	66781
3	Wire insert for 22.5" cooking grate	63075
4	Charcoal grate, V-style, export	66780
5	Bowl, 18.5" Original Kettle/One-Touch Silver, black	65122
6	Handle kit w/hooks, 47 cm Kettle Plus, export	66784
7	Ash catcher, 47 cm Kettle Plus, '17	66792
8	Spring clip (set of 3)	65183
8	Rear leg set, 47 cm kettle plus, export	66787
9	Front ket, 47 cm kettle plus, export	66786
10	Red cap for front leg, Kettle Plus	66788
11	Lid damper w/handle, export	66783
11	Damper handle, black	65829
12	Bezel for thermometer, Charcoal	63027
12	Thermometer w/bezel, 47 cm Kettle Plus w/GBS, export	66785
13	18.5" One-Touch cleaning kit, '12	90992
14	Lid hanger, 47 cm Kettle Plus, export	66782
15	Sleeve red rod damper, Kettle Plus	66793
16	Ash catcher clip (3 piece), EU	66791
17	Wheel w/red insert, 8"	66790
18	Replacement hubcaps (pack of 3)	987101
19	Wheel kit insert, 8", red kettle, 47 cm Kettle plus, export	66789
20	Triangle for 22.5" Bar-B-Kettle, '12	80695
21	Measuring cup, black	80664
22	Large drip pan, single	93100